

RETAIL FOR LEASE ON THE RIVERFRONT

PIER WEST

750 QUAYSIDE DRIVE, NEW WESTMINSTER



SHELDON SCOTT
Personal Real Estate Corporation
604.416.5582
sheldon@sitings.ca

KAYLA MORROW
Senior Associate
604.416.5584
kayla@sitings.ca

SITINGS REALTY LTD.
SITINGS.CA / 604.684.6767
1595 – 650 West Georgia Street, Vancouver, BC V6B 4N8

PROJECT SUMMARY

Pier West is a signature mixed-use development by **Bosa Development**, set along the scenic **Westminster Pier Park**. As a cornerstone of **New Westminster's waterfront revitalization**, Pier West features two striking residential towers—including one of the tallest on Metro Vancouver's waterfront—and a vibrant four-storey commercial space.

Highlights:

- ✦ Premier location in the heart of the Quay District, New Westminster
- ✦ Excellent accessibility via transit, foot traffic, and nearby roadways
- ✦ Ideal for restaurants and cafés, with units offering dedicated outdoor seating
- ✦ Generous surface parking available for both patrons and staff
- ✦ Stunning riverfront setting, perfect for an elevated customer experience



This document/email has been prepared by Sitings Realty Ltd. for advertising and general information only. Although information contained herein is from sources we believe reliable, Sitings Realty Ltd. makes no guarantees, representations or warranties of any kind, expressed or implied, regarding the information including, but not limited to, warranties of content, accuracy and reliability. This document/email is subject to errors and omissions and any interested party should undertake their own inquiries as to the accuracy of the information. Sitings Realty Ltd. excludes unequivocally all inferred or implied terms, conditions and warranties arising out of this document and excludes all liability for loss and damages arising there from. All areas, measurements and dimension herein are approximate, interested parties/tenant are to verify measurements if important to them. This document/email is not an inducement representation.

DETAILS

COMMERCIAL BUILDING

Ground Level:

CRU 2*: 872 SF

CRU 3*: 1,116 SF

Total: 1,988 SF

Patio: 1,000 SF (approx.) in front of CRU 2 & 3

Ceiling Height: Up to 14 ft. (approx.)

*Available Q1 2027

Daycare (2nd & 3rd Floors): LEASED

Commercial/Public Parking: 97 stalls (pay parking)

Basic Rent: Contact Listing Agents

Additional Rent (2026): \$25.06 PSF

Access to underground parkade at roundabout on Quayside Drive

CONTACTS

SHELDON SCOTT

Personal Real Estate Corporation

604.416.5582

sheldon@sitings.ca

KAYLA MORROW

Senior Associate

604.416.5584

kayla@sitings.ca

DEMOGRAPHICS

Drive Time	3min	7min	12min
2025 Population	12,269	68,805	255,563
2030 Populations Projections	12,830	71,573	277,424
2025 Daytime Population	15,041	61,570	237,045
2025 Average HH Income	\$114,531	\$118,119	\$121,281

AREA RETAILERS



RIVER MARKET
NEW WESTMINSTER BC



CITY AVENUE
MARKET

THE BOATHOUSE
RESTAURANT
ESTABLISHED 1981

FLOOR PLAN - COMMERCIAL BUILDING

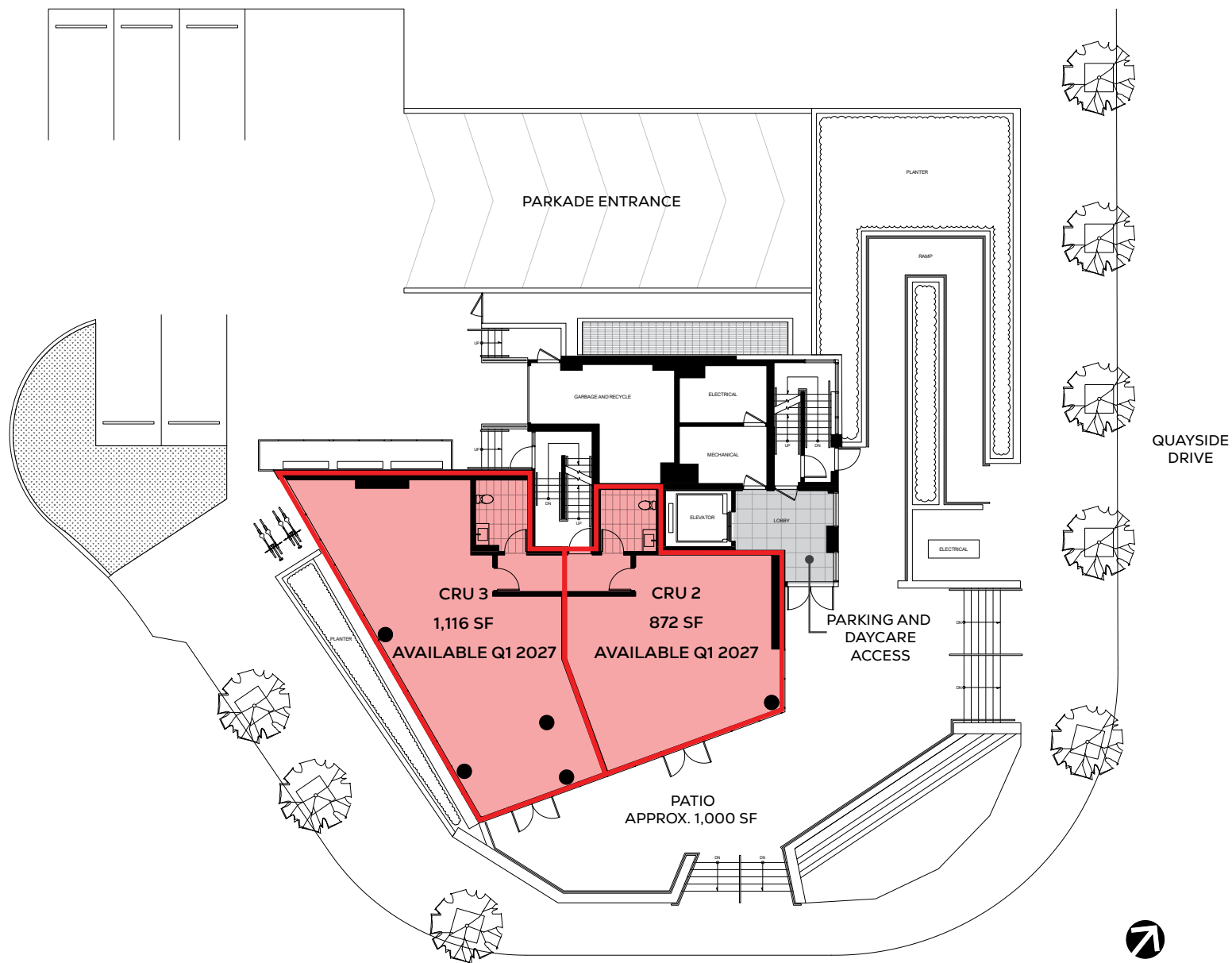

AERIAL



This document/email has been prepared by Sitings Realty Ltd. for advertising and general information only. Although information contained herein is from sources we believe reliable, Sitings Realty Ltd. makes no guarantees, representations or warranties of any kind, expressed or implied, regarding the information including, but not limited to, warranties of content, accuracy and reliability. This document/email is subject to errors and omissions and any interested party should undertake their own inquiries as to the accuracy of the information. Sitings Realty Ltd. excludes unequivocally all inferred or implied terms, conditions and warranties arising out of this document and excludes all liability for loss and damages arising therefrom. All areas, measurements and dimension herein are approximate, interested parties/tenant are to verify measurements if important to them. This document/email is not an inducement representation.

RENDERINGS



Waterfront Esplanade Boardwalk



CRU 2 & 3 AVAILABLE Q1 2027

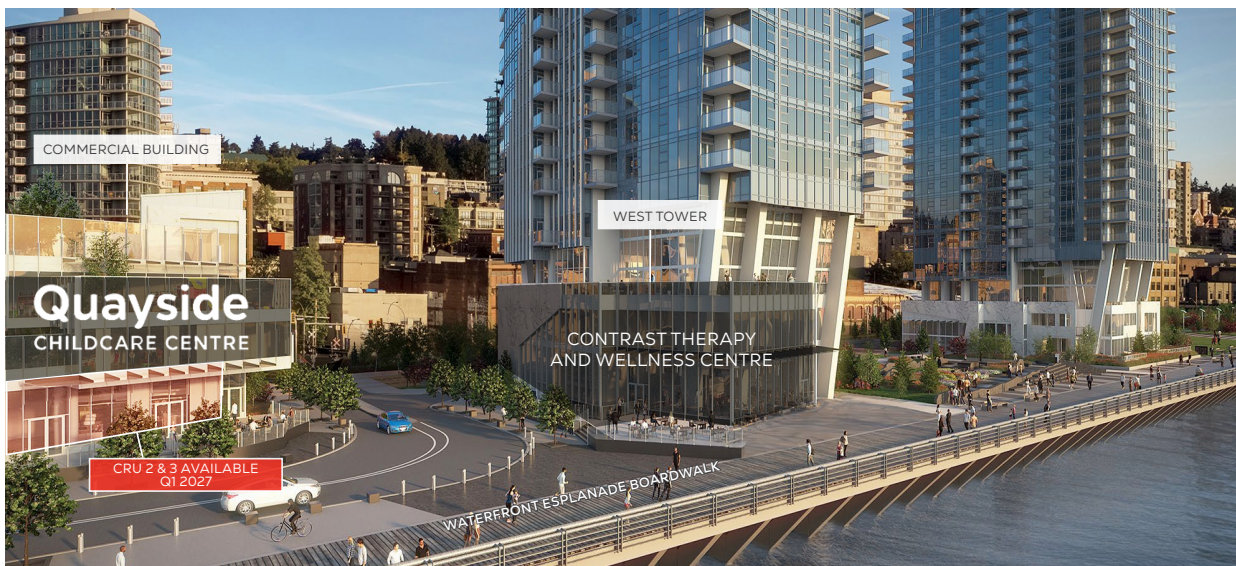

CRU 2 & 3 AVAILABLE Q1 2027